

Product ID: 32 • Diagram ID: 165

Deck & Belt Assy

Waxable System

Callout	Part Number:	Description
1	130-1630	Belt, Running, 20x128.5"
2	708-0061	Roller, Head
3	715-3431	Roller, Tail, Pro Treads
4	800-3874	Deck, dbl-sided, Pro Tread
5	010-3106	Deck Rubber, 53.5"
6	130-1695	Belt, Drive, 270J10, Poly-V
7	140-3180	Wax, Bottle, 4oz (3-4 waxings)
8	800-3146	Wax, Bag, 8oz (6-8 waxings)
9	110-3066	Screw, 6x5/8" Truss Hd Phil
10	140-3216	Bumper, Recessed 5/8x13/32
11	120-0341	Washer, #10 Flat Sae
12	110-3056	Screw, 5/16-18x2.0" Shcs
13	110-0651	Screw, 5/16-18x1.75" Shcs Thr
14	120-0496	Washer, 5/16" Lock
15	120-0490	Washer, 5/16 x1/2" Flat
16	020-6388	Brkt, Deck Stop
17	110-3109	Screw, 10-24x1/2" Shcs

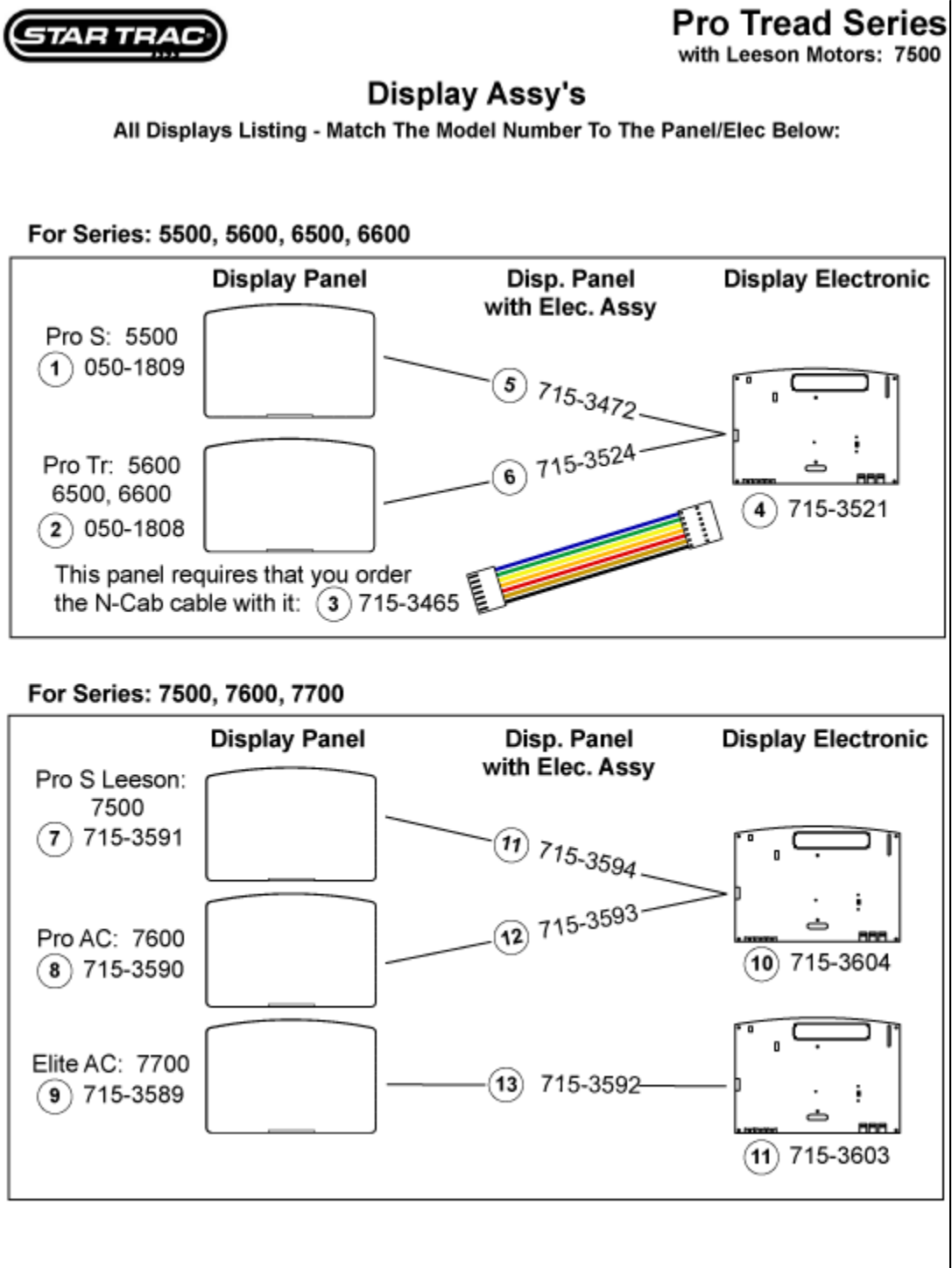

Display Assy Complete Listing

Callout	Part Number:	Description
1	050-1809	Disp Panel, 5500
2	050-1808	Disp Panel, 5600/6500/6600
3	715-3465	Cable, N-cap Pwr for 050-1808
4	715-3521	Disp Elec, Pcb, Pro Treads
5	715-3472	Disp Assy, Panel+Elec 5500
6	715-3524	Disp Assy, Panel+Elec 56\65\66
7	715-3591	Disp Panel, 7500
8	715-3590	Disp Panel, 7600
9	715-3589	Disp Panel, 7700
10	715-3604	Disp Elec w/Saltrn, Pro/S AC/L
11	715-3603	Disp Elec w/Saltrn, Elite AC
12	715-3594	Disp Assy, Panel+Elect, 7500
13	715-3593	Disp Assy, Panel+Elect, 7600
14	715-3592	Disp Assy, Panel+Elect, 7700

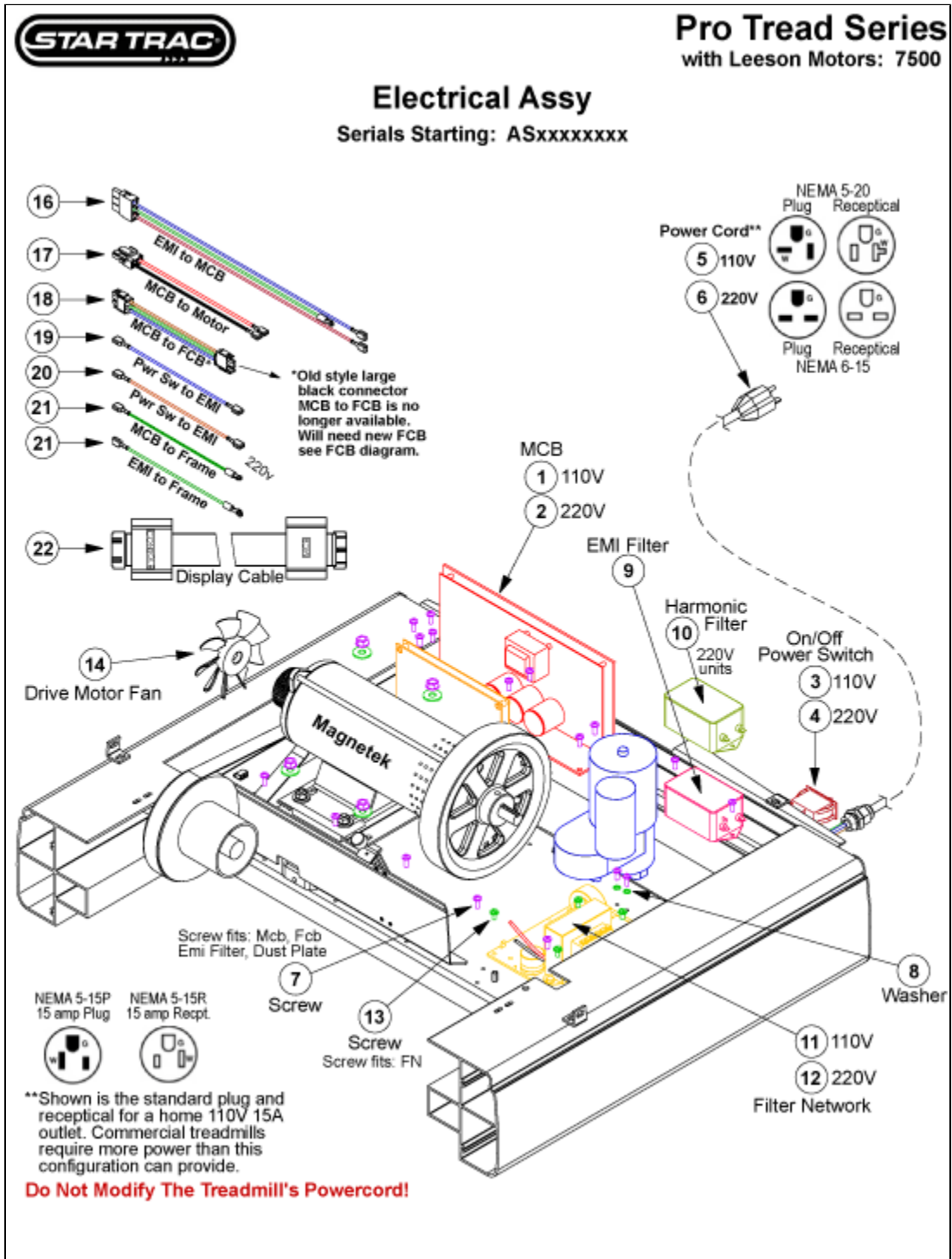

Electrical Assy

Callout	Part Number:	Description
1	715-3541	Mcb, 110v, Pro Tr, Leeson
2	715-3542	Mcb, 220v, Pro Tr, Leeson
3	470-0190	Switch, Pwr, On/off Brkr, 110v 18a
4	470-0180	Switch, Pwr, On/off Brkr, 220v 18a
5	715-3456	ASSY, PW CORD, NEMA 5-20, 110V
6	712-3002	ASSY, PW CORD, NEMA 6-20, 220V
7	110-3026	Screw, 10-24x3/4" Phtcs
8	120-0220	Washer, #10 Ext Tooth
9	440-0257	EMI Fltr, 110/220v
16	715-3412	Cable, Power, EMI-Mcb
17	715-3554	Assy, Cable, Mcb Interface
19	715-3413	Cable, Brkr-EMI
20	715-3413	Cable, Brkr-EMI
21	715-3457	Cable, Ground Wire
22	715-3411	Disp Cable (Data)

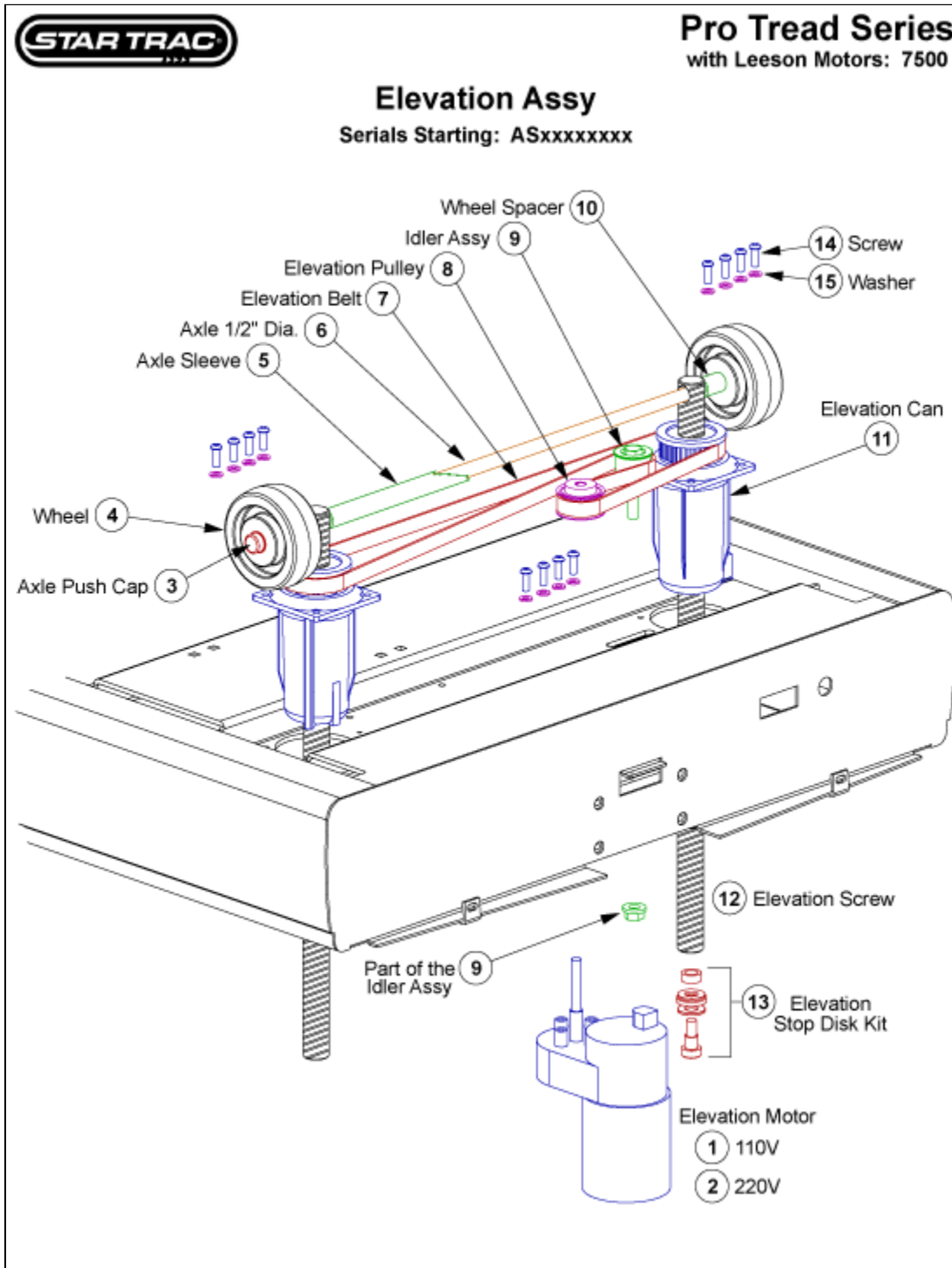

Product ID: 32 • Diagram ID: 168

Elevation Assy

Callout	Part Number:	Description
1	260-0235	Motor, Elev, 110vac
2	260-0929	Motor, Elev, 220vac
3	110-1415	Axle Push Cap, 1/2"
4	130-1694	Wheel, 4x1.5x1/2" bore
5	020-6266	Sleeve, Elev Axle
6	715-3430	Elev Axle, 1/2" dia
7	130-0050	Belt, Elev, 1595-5M15
8	130-0250	Pulley, Elev Mtr, 2/3/15/1000
9	800-0225	Elev, Idler Pulley Assy
10	020-6268	Spacer, Elevation
11	708-0151	Elev Can
12	715-0110	Elev Screw, Drilled
13	800-3267-001	Elev Stop Disk, Retro Kit, Rbr
14	110-3119	Screw, 1/4-20x3/4" Bhcs,loctite
15	120-0420	Washer, 1/4" Lock

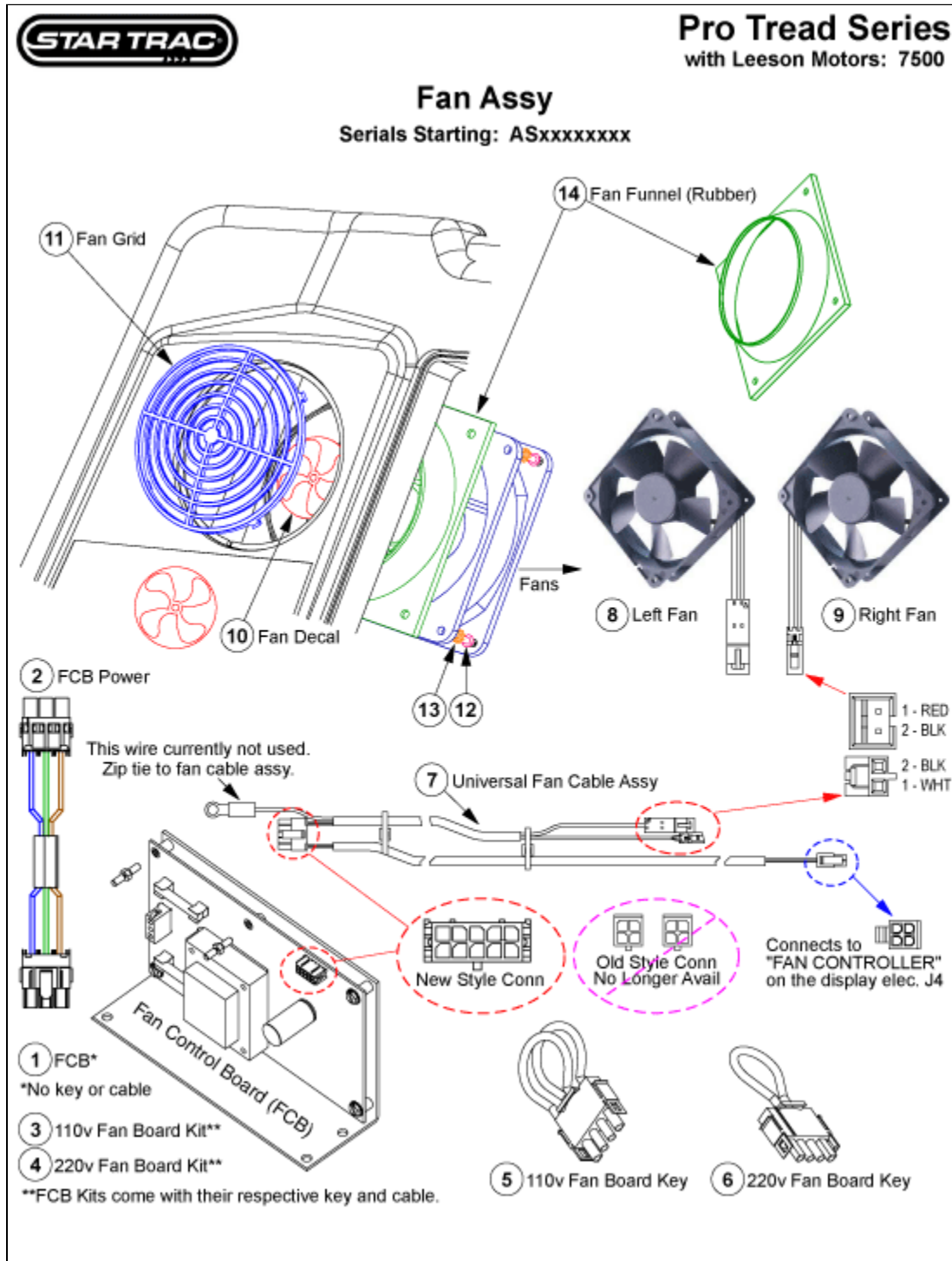

Product ID: 32 • Diagram ID: 169

Fan Assy

Callout	Part Number:	Description
1	715-3549	FCB Assy, 110-220V
2	715-3545	Cable, Fan Power, Mcb-Fcb
3	800-3871	Fcb, w/Wires 110v, PRO TR
4	800-3872	Fcb, w/Wires 220v, PRO TR
5	715-3544	Jumper Cable, 110v, Fan Brd
6	715-3543	Jumper Cable, 220v, Fan Brd
7	715-3522	Fan Wiring Assy
8	260-0928-01	Fan, Dc Brushless, Lt
9	260-0928-02	Fan, Dc Brushless, Rt
10	050-1826	Sticker, Fan, Pro Tr
11	020-6273	Fan Grid, Pro Tr
12	110-0150	Screw, 6-32x1/2" Bhc,hk,as
13	120-3233	Washer, #6 Ext Tooth
14	020-6287	Funnel, Fan

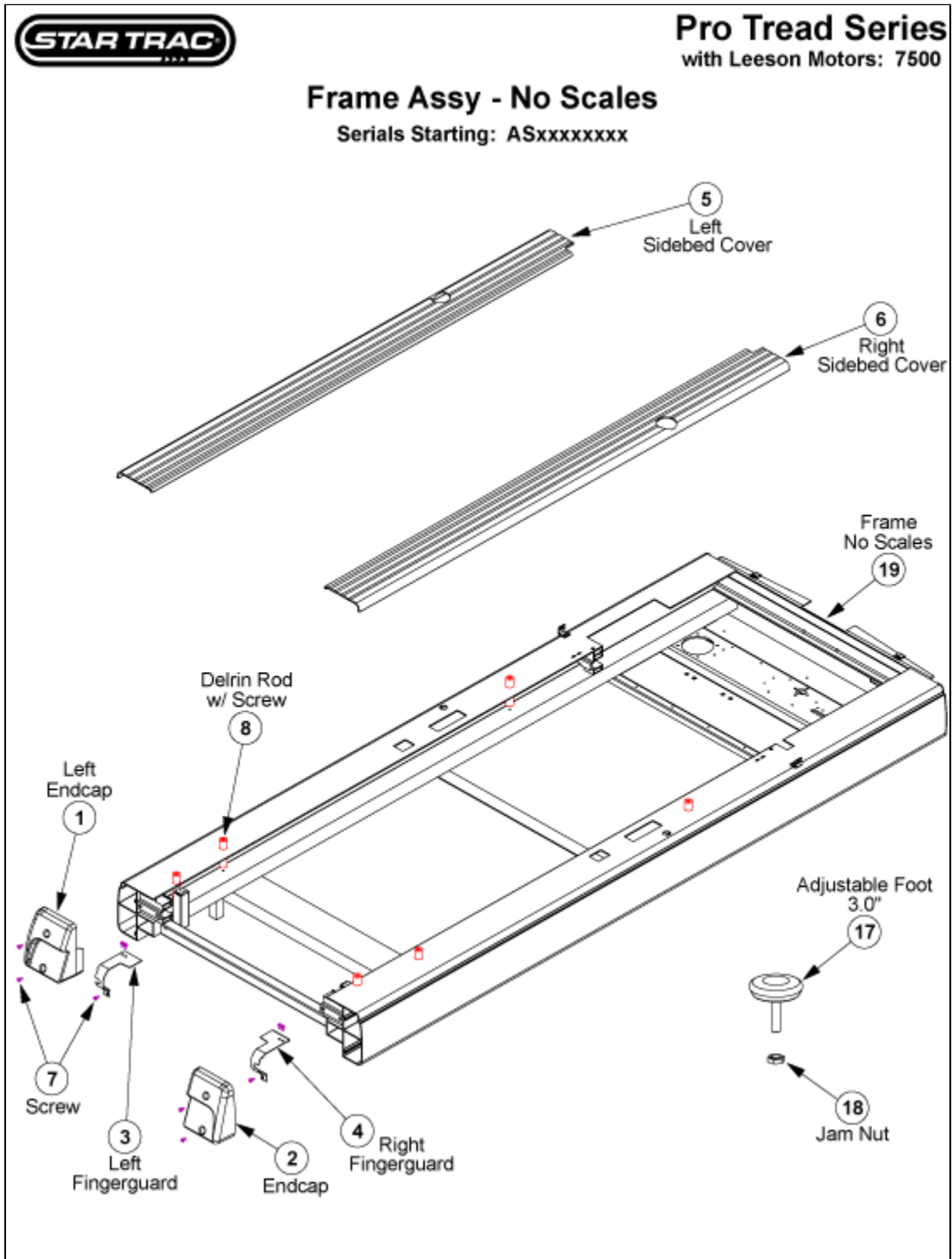

Product ID: 32 • Diagram ID: 170

Frame Assy

No Scales

Callout	Part Number:	Description
1	020-6241-01	Endcap, Lt, PRO TR
2	020-6241-02	Endcap, Rt, PRO TR
3	020-6231-01	Finger Guard, Lt
4	020-6231-02	Finger Guard, Rt
5	020-6344-01	Sidebed Cover Extr, Lt, Pro Tr
6	020-6344-02	Sidebed Cover Extr, Rt, Pro Tr
7	110-0475	Screw, 10-32x1/2" Phcs, Blk Oxd
8	715-3196	Delrin Stop Rod w/screw
17	140-3200	Adjustable Foot, 1/2-13x3.0"
18	110-1823	Nut, 1/2-13x5/16" Jam

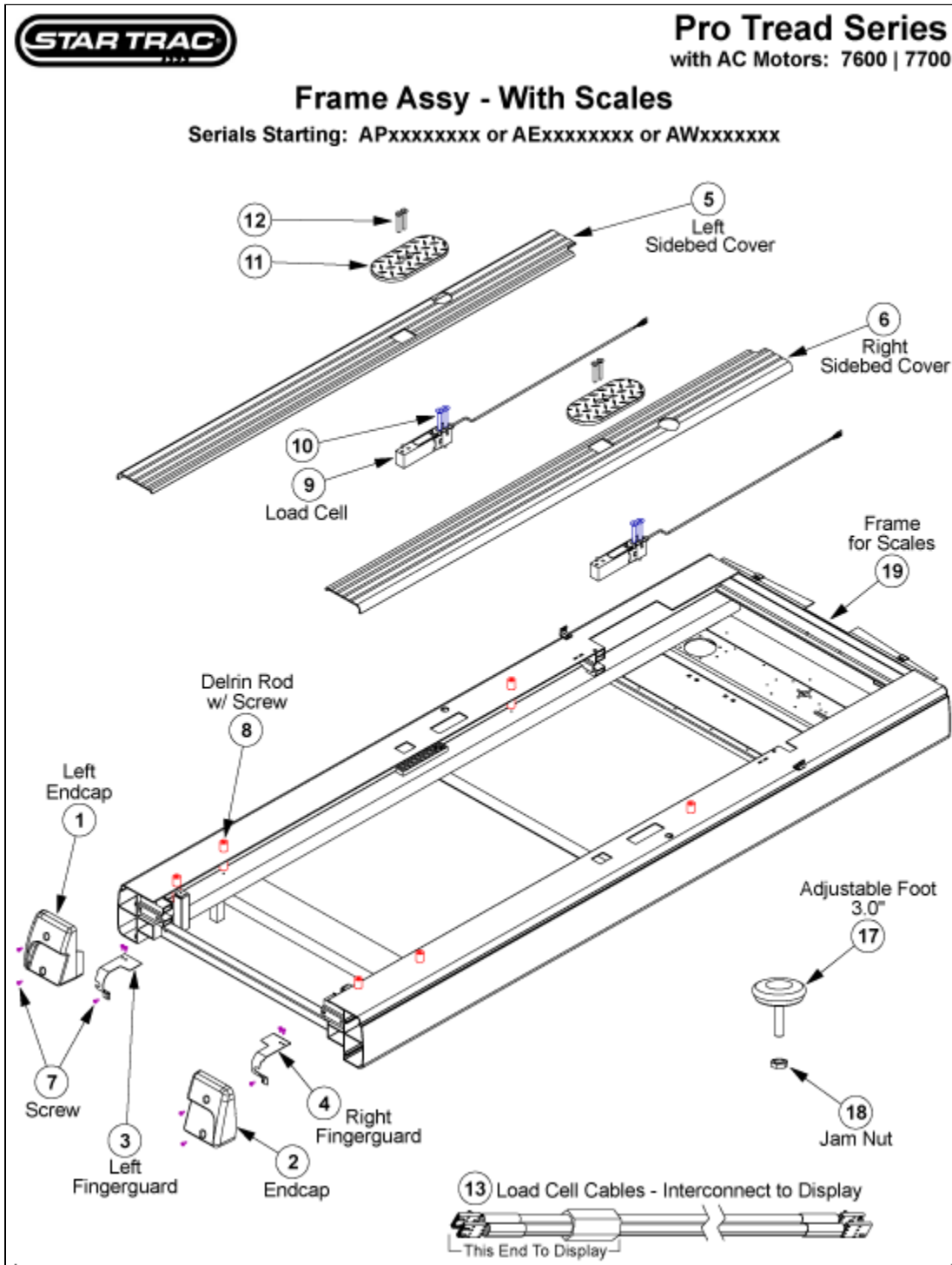

Product ID: 32 • Diagram ID: 171

Frame Assy With Scales

Callout	Part Number:	Description
1	020-6241-01	Endcap, Lt, PRO TR
2	020-6241-02	Endcap, Rt, PRO TR
3	020-6231-01	Finger Guard, Lt
4	020-6231-02	Finger Guard, Rt
5	020-6245-01	Sidebed Cover Extr, Lt, Pro Tr
6	020-6245-02	Sidebed Cover Extr, Rt, Pro Tr
7	110-0475	Screw, 10-32x1/2" Phcs, Blk Oxd
8	715-3196	Delrin Stop Rod w/screw
9	715-3502	Load Cell, Pcu-175lb
10	110-3159	Screw, 5/16-18x2.0" Hk,shf,as,b
11	020-6285	Support, Foot pLatform
12	110-3149	Screw, 5/16-18x2.5" Fhsc, Ss
13	715-3418	Cable, Load Cell, Intercn-Disp
17	140-3200	Adjustable Foot, 1/2-13x3.0"
18	110-1823	Nut, 1/2-13x5/16" Jam
19	710-3134	Frame, Painted

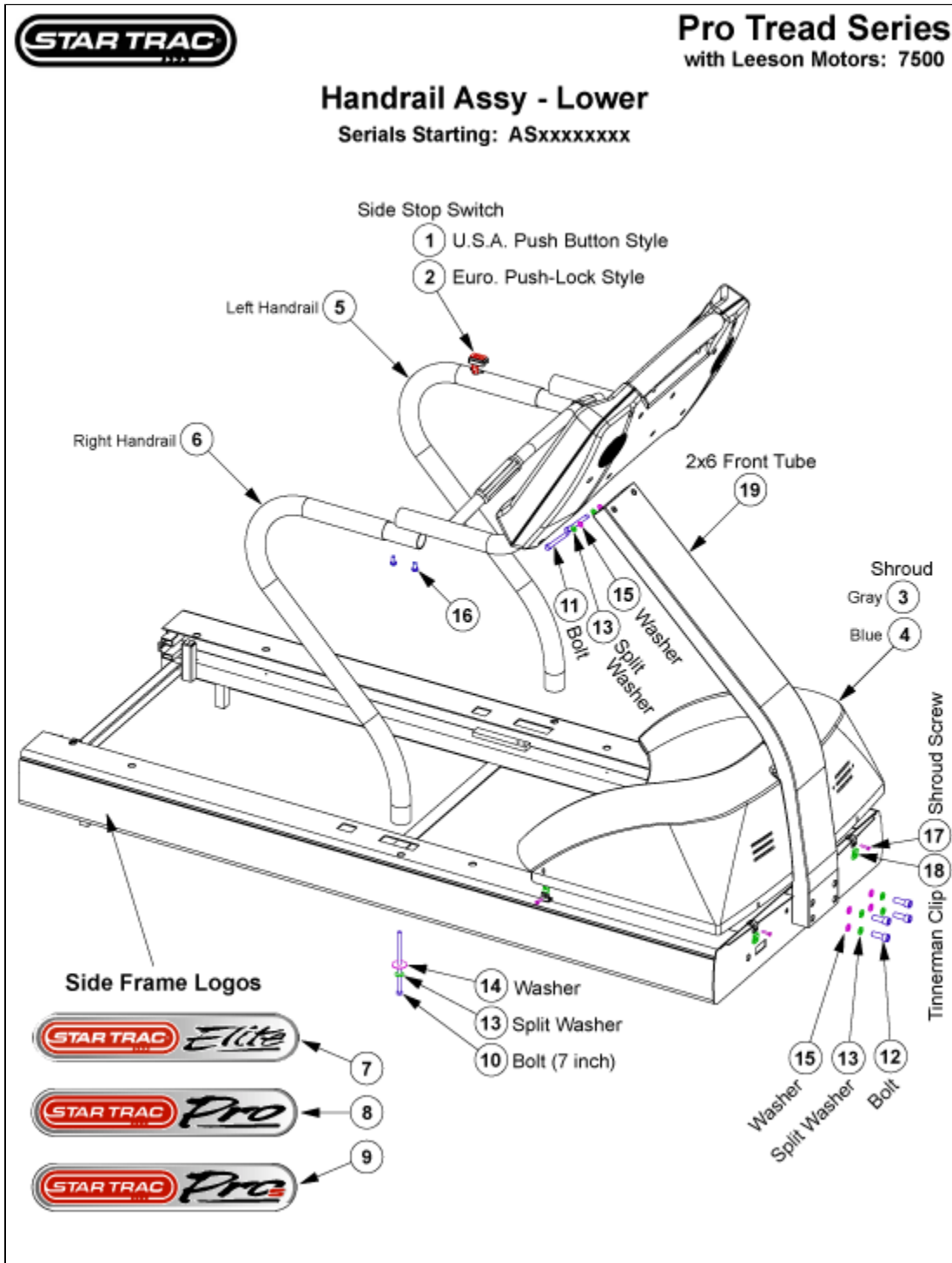

Product ID: 32 • Diagram ID: 172

Handrail Assy

Lower Section

Callout	Part Number:	Description
1	715-3565	Switch, Stop w/Cable, Pro Tr
3	800-3957	Shroud Kit, w/Logo, gry
4	020-6485	Shroud, Motor, d-blu
5	020-6239	Rail, Side, Lt
6	020-6240	Rail, Side, Rt
7	050-1886	Label, Logo, Frame, Elite
8	050-1822	Label, Logo, Frame, Pro Tr
9	050-1824	Label, Logo, Frame, Pro S
10	110-3162	Screw, 5/16-18x7.0" Cch,he,cs,z
11	110-0640	Screw, 5/16x3.0" Shcs
12	110-3150	Screw, 5/16-18x1.0" Shcs
13	120-0480	Washer, 5/16" Cut
14	120-0491	Washer, 5/16 x 1.5" Flat
15	120-0490	Washer, 5/16 x 1/2" Flat
16	110-0506	Screw, 1/4-28x3/8" Bhss
17	110-3107	Screw, 10-24x7/8" Rolok, Pphs
18	140-3149	Tinnerman Clip, #10 nut
19	715-3563	*Alt* Use Part # 715-3632

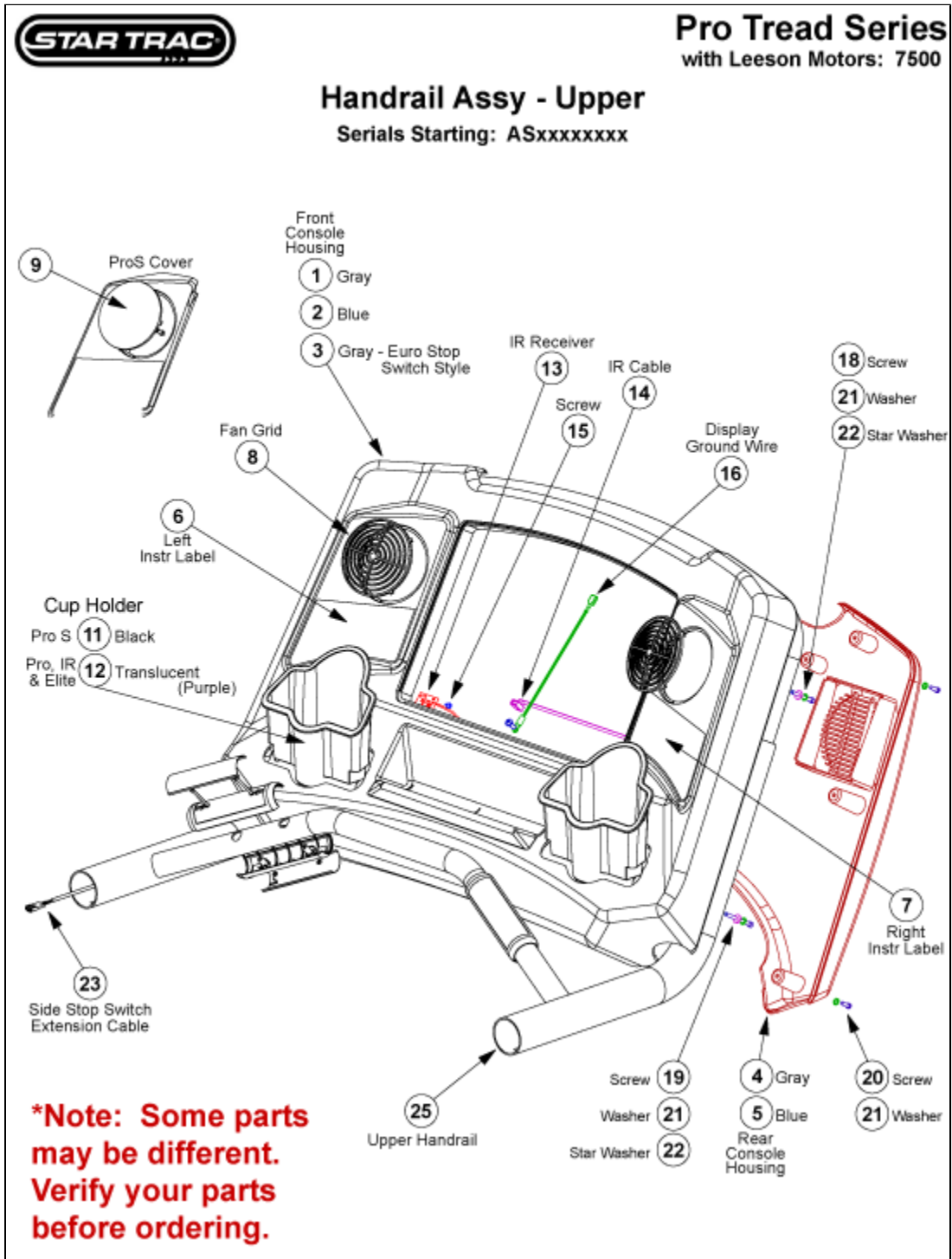

Product ID: 32 • Diagram ID: 173

Handrail Assy

Upper Section

Callout	Part Number:	Description
1	020-6269	Disp Hsg, Front, gry
2	020-6486	*OBSOLETE*
4	020-6270	Disp, Back, gry
5	020-6487	Disp, Back, d-blu
6	050-1904-01	Instr, Oper, Engr, Pro Tr, Lt
7	050-1904-02	Instr, Oper, Engr, Pro Tr, Rt
8	020-6273	Fan Grid, Pro Tr
9	020-6345	Disp, Fan Cover
11	020-6272-01	Disp Pocket, Black
12	020-6272	Disp Pocket, Translucent
13	715-3427	Daughterboard, IR
14	110-3158	Screw, 6-19bx1/4" Pht
15	715-3450	Cable, IR-Disp Extn
16	715-3457	Cable, Ground Wire
18	110-3157	Screw, 8-32x1.5" Shcs
19	110-3144	Screw, 8-32x2.5" Shcs
20	110-3145	Screw, 8-32x1/2" Fillister
21	120-0590	Washer, #8 Flat
22	120-0221	Washer, #8 Ext tooth
23	715-3416	Cable Assy, Stop Sw, Extn
25	020-6237	Hrail, Top, Hr



Pro Tread Series
 5500 | 5600 | 6500 | 6600 | 7500 | 7600 | 7700

Hardware for Installation

There is no part number for the installation hardware for the Pro Treadmills. Below is a listing of the screws and washers that are needed to install the treadmill:

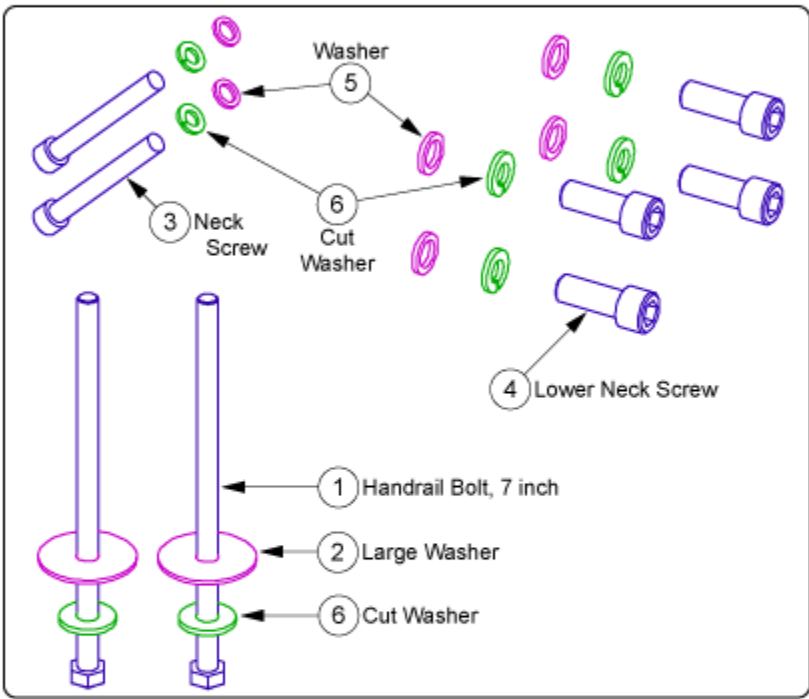

2x 110-3162
 2x 120-0491
 2x 110-0640
 4x 110-3150
 6x 120-0490
 8x 120-0480

Below are some other commonly ordered hardware parts for your reference:



11 Tinnerman Clip (Motor Shroud)



12 Shroud Screw



13 Handrail Screw



14 Star Washer (Display Panel)



15 Display Screw

Product ID: 32 • Diagram ID: 427

Hardware (Installation)

Callout	Part Number:	Description
1	110-3162	Screw, 5/16-18x7.0" Cch,he,cs,z
2	120-0491	Washer, 5/16 x 1.5" Flat
4	110-3150	Screw, 5/16-18x1.0" Shcs
5	120-0490	Washer, 5/16 x1/2" Flat
6	120-0480	Washer, 5/16" Cut
11	140-3149	Tinnerman Clip, #10 nut
12	110-3107	Screw, 10-24x7/8" Rolok, Pphs
13	110-0506	Screw, 1/4-28x3/8" Bhss
14	120-0221	Washer, #8 Ext tooth
15	110-3145	Screw, 8-32x1/2" Fillister

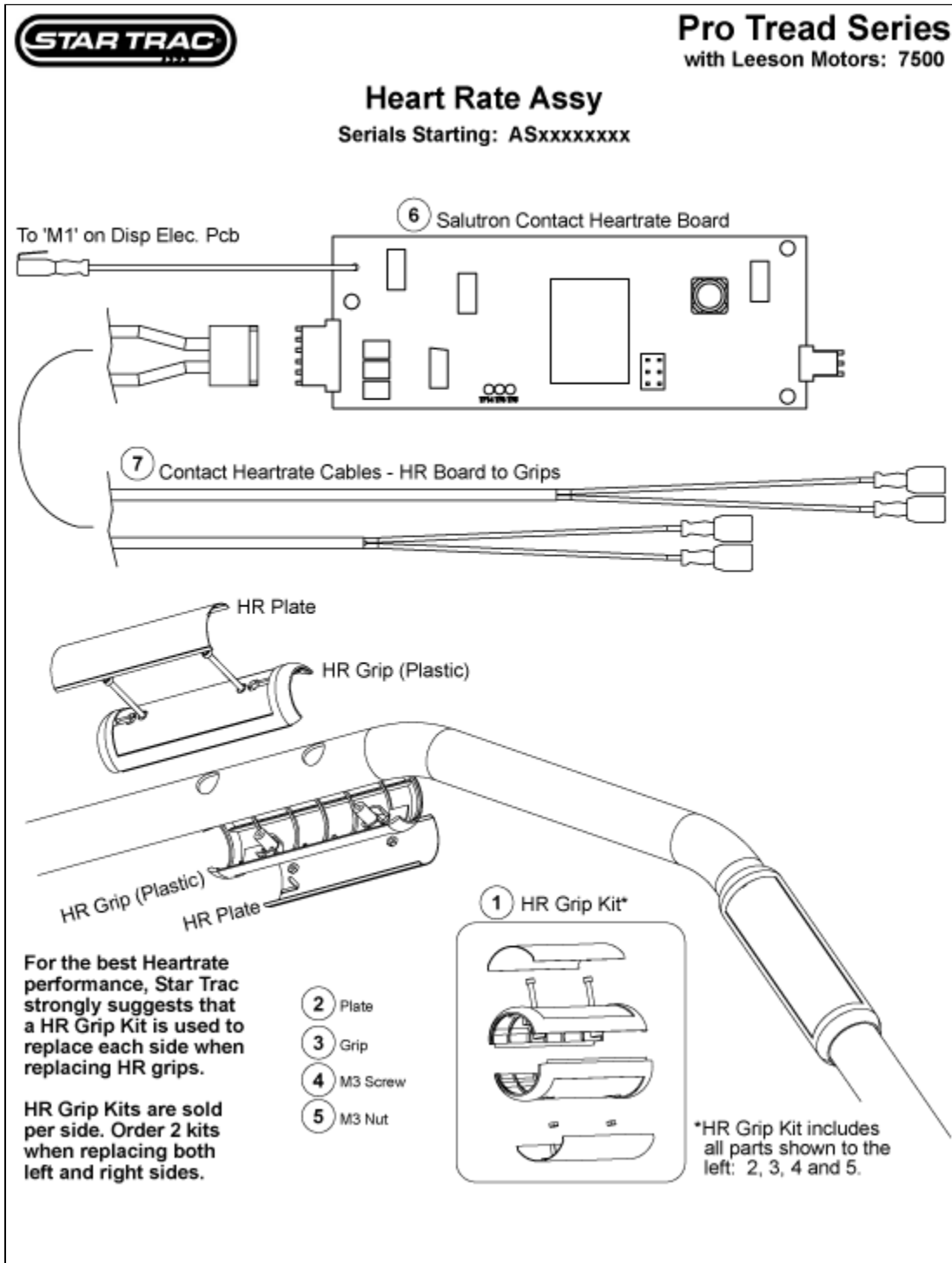

Product ID: 32 • Diagram ID: 174

Heart Rate Assy

Callout	Part Number:	Description
1	800-3904	HR Grip Kit, one side
2	020-6350	*Use Kit # 800-3904
6	715-3602	Salutron HR Brd w/Grd wire
7	715-3425	Splitter, HR Grip

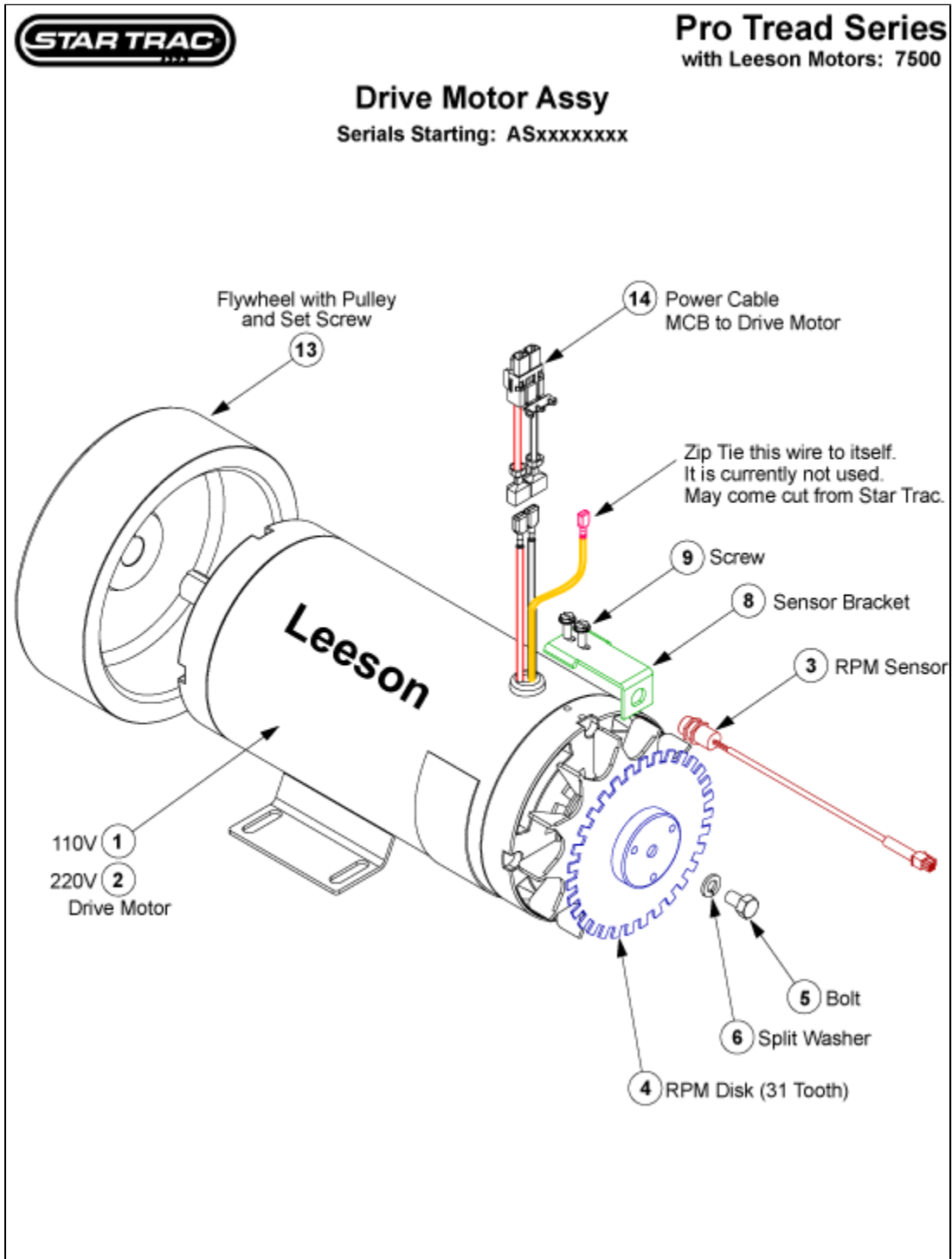

Product ID: 32 • Diagram ID: 175

Drive Motor Assy

Leeson Motor

Callout	Part Number:	Description
1	260-0926	Motor, Drive, 110v leeson
2	260-0927	Motor, Drive, 220v leeson
3	715-3414	Rpm Sensor, w/Molex Conn
4	715-3455	Rpm Disk
5	110-0687	Screw, 5/16-18x1/2" Hhcs
6	120-0495	Washer, 5/16" Cut
8	020-6347	Brkt, Rpm Support
9	110-3152	Screw, 8-32x1/2" Hhms w/washer
13	020-6278	Pulley & Flywheel Combined
14	715-3554	Assy, Cable, Mcb Interface

TREADMILLS

Power Cord Assy's















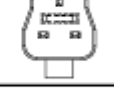
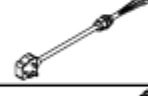
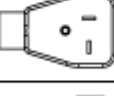

9-xxxx-x**USA**xx

110V 220V

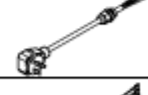
← 12.0ft 144.00in (+1.00/-0.00) →

3.66m 365.75cm (+2.50/-0.00)



USA OUL		① Power Cord 110V NEMA 5-20		
	USA OUL JPN	② Power Cord 220V NEMA 6-15		
	OCE	③ Power Cord 220V CEE 7/7		
	AUS	④ Power Cord 220V Australia		
	UKI	⑤ Power Cord 220V BS1363 fused		
USA OUL		⑥ Power Cord 110V - Right Angle Plug NEMA 5-20rt		
	USA OUL JPN	⑦ Power Cord 220V - Right Angle Plug NEMA 6-15rt		
	UKI	⑧ Power Cord 220V - Right Angle Plug CEE 7/7		
USA		⑨ Power Cord, Home Units 110V NEMA 5-15		
USA		⑩ Power Cord, Home Units 110V - Right Angle Plug NEMA 5-15rt		

DO NOT MODIFY THE POWER CORD THAT CAME WITH YOUR TREADMILL. USE THE SAME TYPE. DO NOT USE A HOME MODEL PLUG ON A COMMERCIAL TREADMILL. CONTACT STAR TRAC FOR INFO.

Product ID: 32 • Diagram ID: 432

Power Cords

Callout	Part Number:	Description
1	715-3456	ASSY, PW CORD, NEMA 5-20, 110V
2	712-3002	ASSY, PW CORD, NEMA 6-20, 220V
3	712-3033	POWER CORD, ASSY, 230V, EUROPEAN
4	712-3046	Power Cord, 220v, Aus
5	712-3035	POWER CORD, 230V, UK/IRELAND
6	715-3456-001	ASSY, PW CORD, NEMA 5-20, 110V, RA
7	712-3002-001	Power Cord, 220v, right angle
8	715-3570	Assy, Powercord, 230v, Eur, Rt
10	800-3956	Power Cord, 110v, nema 5-15rt